

FOR LEASE

# 152 WEST STREET

SOUTH PLAINFIELD | NEW JERSEY

±21,360 SF FACILITY ON ±4.1 ACRES

UNIQUE LOW COVERAGE  
SITE IN THE HEART OF  
MIDDLESEX COUNTY

EXIT  
4

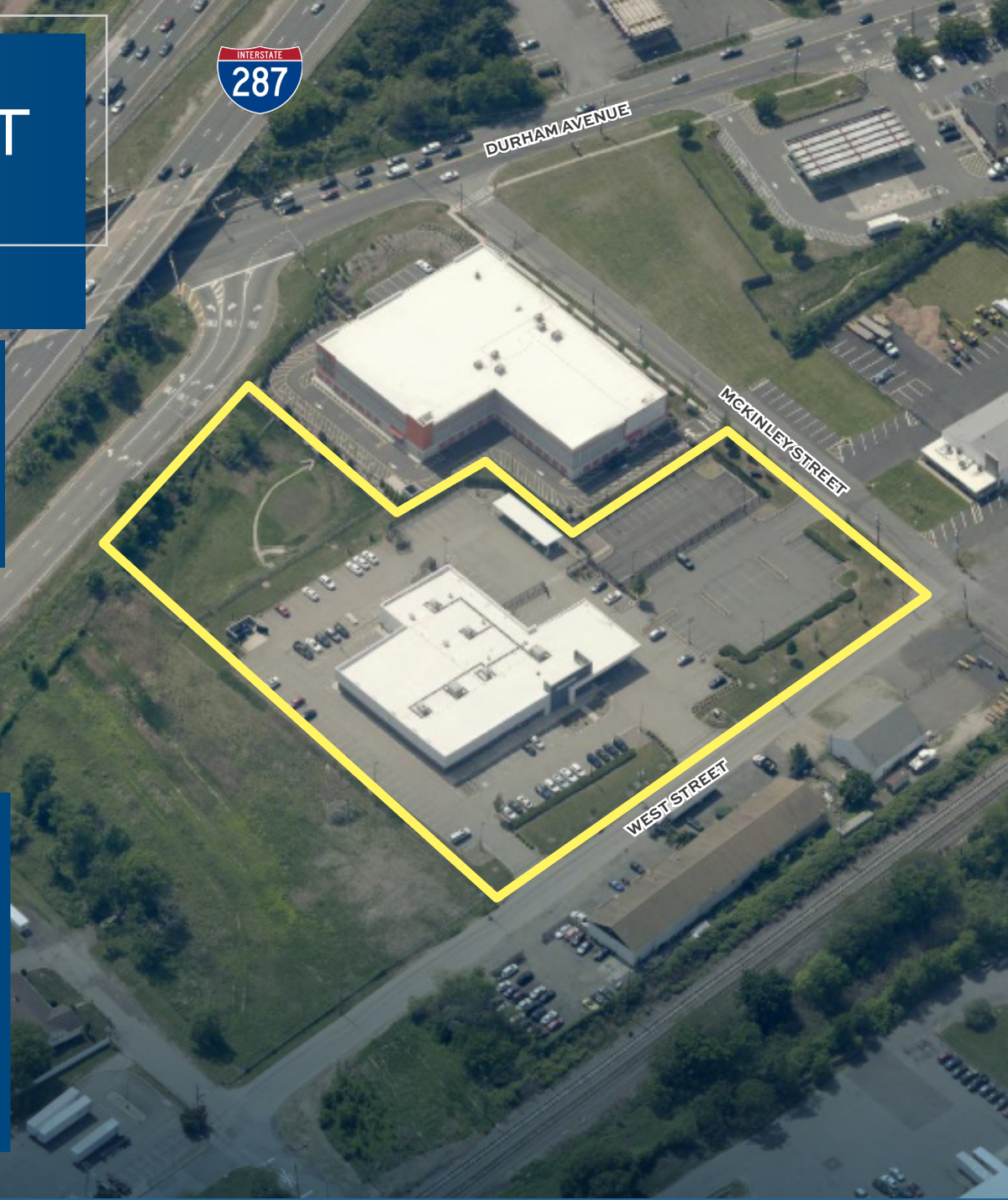

[WWW.152WESTSTREET.COM](http://WWW.152WESTSTREET.COM)

SITEX  
GROUP

CBRE

# BUILDING SPECIFICATIONS

FOR LEASE

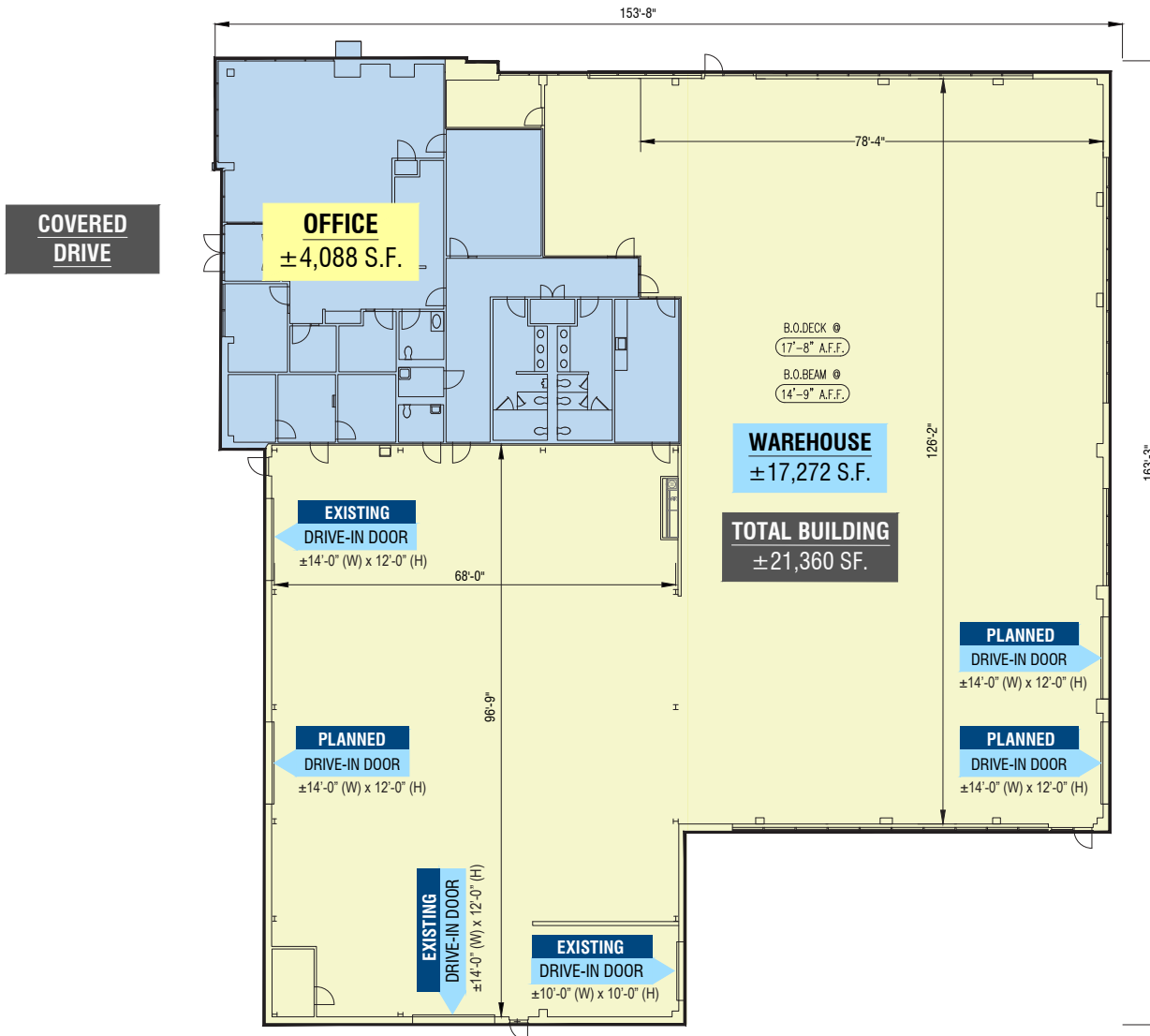

<b>BUILDING SIZE</b>	21,360 sq. ft.
<b>WAREHOUSE SPACE</b>	17,272 sq. ft.
<b>OFFICE SPACE</b>	4,088 sq. ft.
<b>LOT SIZE</b>	4.1 acres
<b>CLEAR HEIGHT</b>	14' 9"
<b>DRIVE-IN DOORS</b>	6 (3 existing)
<b>CAR PARKING</b>	180
<b>POWER</b>	800 amp 3 phase 4 wire 120/208-volt service
<b>PLANNED IMPROVEMENTS</b>	<ul style="list-style-type: none"> <li>• 3 new drive-in doors</li> <li>• Upgrade office</li> <li>• Mill &amp; pave parking lot</li> <li>• New fire sprinkler system</li> <li>• Landscaping</li> <li>• Oil / water separator</li> </ul>
<b>ZONING</b>	Approved for vehicle maintenance, parking and limited outdoor storage

# SITE PLAN

FOR LEASE

**SIGNAGE  
OPPORTUNITY  
VISIBLE FROM  
ROUTE 287 / EXIT 10**



# LOCAL AREA MAP

FOR LEASE

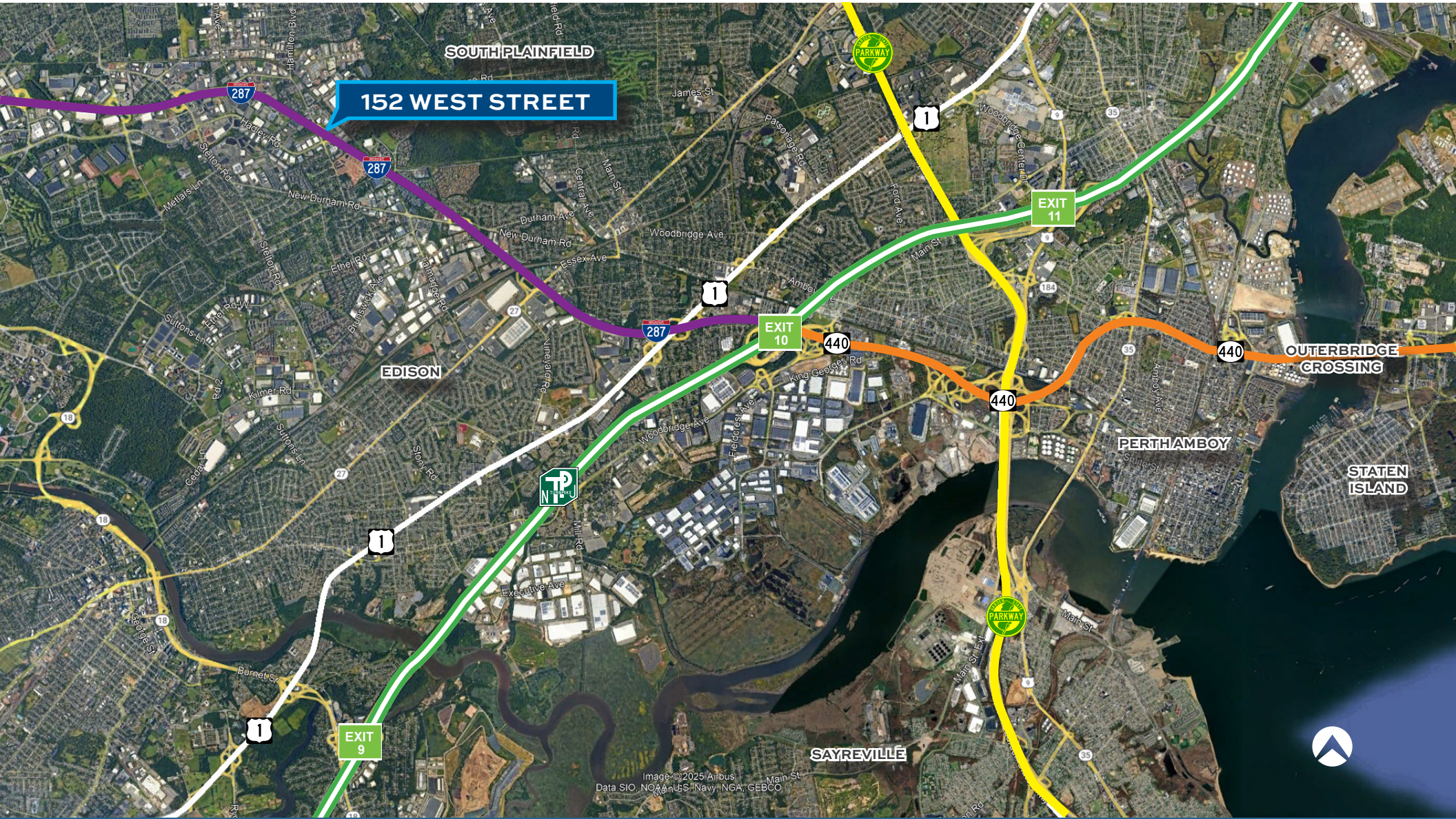







152 WEST STREET | SOUTH PLAINFIELD, NJ  
WWW.152WESTSTREET.COM



# LOCATION HIGHLIGHTS

FOR LEASE

	NEW JERSEY TURNPIKE EXIT 10	5 MILES
	NEW JERSEY TURNPIKE EXIT 11	9 MILES
	OUTERBRIDGE CROSSING	11 MILES
	NEWARK LIBERTY INT'L AIRPORT	21 MILES
	PORTS NEWARK / ELIZABETH	28 MILES
	HOLLAND TUNNEL	32 MILES
	LINCOLN TUNNEL	36 MILES

152 WEST STREET

5 MILES

10 MILES

15 MILES

20 MILES

25 MILES

30 MILES

152 WEST STREET | SOUTH PLAINFIELD, NJ

[WWW.152WESTSTREET.COM](http://WWW.152WESTSTREET.COM)

SITEX  
GROUP

CBRE

# EXAMPLE FINISHED PRODUCT

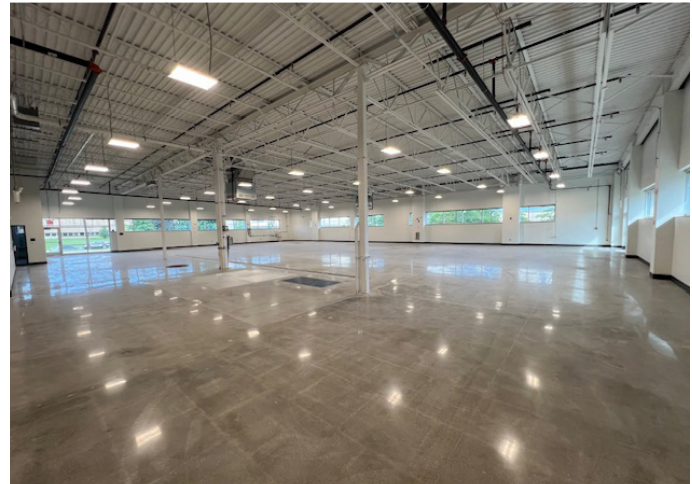



# 152 WEST STREET

SOUTH PLAINFIELD | NEW JERSEY

[WWW.152WESTSTREET.COM](http://WWW.152WESTSTREET.COM)

## CONTACT US

### LARRY SCHIFFENHAUS

Vice Chairman

o +1 201 712 5809

c +1 201 532 5092

[larry.schiffenhaus@cbre.com](mailto:larry.schiffenhaus@cbre.com)

### THOMAS F. MONAHAN

Vice Chairman

o +1 201 712 5610

c +1 973 568 6614

[thomas.monahan@cbre.com](mailto:thomas.monahan@cbre.com)

### BRIAN GOLDEN

Executive Vice President

o +1 201 712 5607

c +1 732 284 8451

[brian.golden@cbre.com](mailto:brian.golden@cbre.com)

### ANDREW GUNST

Senior Associate

o +1 201 712 5649

c +1 908 642 1415

[andrew.gunst@cbre.com](mailto:andrew.gunst@cbre.com)

### EVAN BERNARD

Vice President

o +1 201 712 5646

c +1 973 525 7886

[evan.bernard@cbre.com](mailto:evan.bernard@cbre.com)

